

San Gabriel

1,835 Sq. Ft.
3 Bedrooms | 2 Bathrooms

TILSON
CUSTOM HOME BUILDERS



Elevation D



Elevation B



Elevation C

View more models and options at:

www.TilsonHomes.com

© Copyright 2019, Tilson Home Corporation

Design Centers

Angleton	Bryan	Katy	San Marcos	Waxahachie
Boerne	Georgetown	McKinney	Spring	Weatherford

*Printed on demand and in-house to help reduce the amount of paper being used.

Elevation D

The San Gabriel offers a modern, open concept design. The large family room features raised ceilings and plenty of space to entertain. The kitchen includes walls of cabinets, a work island and a large eating bar. The San Gabriel also boasts two covered porches and an oversized utility room. The master suite features a huge walk-in closet, a soaking tub and dual vanities. Tour the fully furnished model at our Georgetown Design Center.

Available Custom Options

- Upstairs Bonus Room
- Walk-In Pantry & Drop Zone
- Attached 2 Car Garage
- Bedroom 4
- Family Room Cathedral Ceilings
- Remove Column in Kitchen
- Extended Dining Room
- Fireplace
- Powder Room
- Study Instead of Bedroom 3
- Walk-In Shower

Change this plan any way you want. Move a wall, add a room - Just ask!

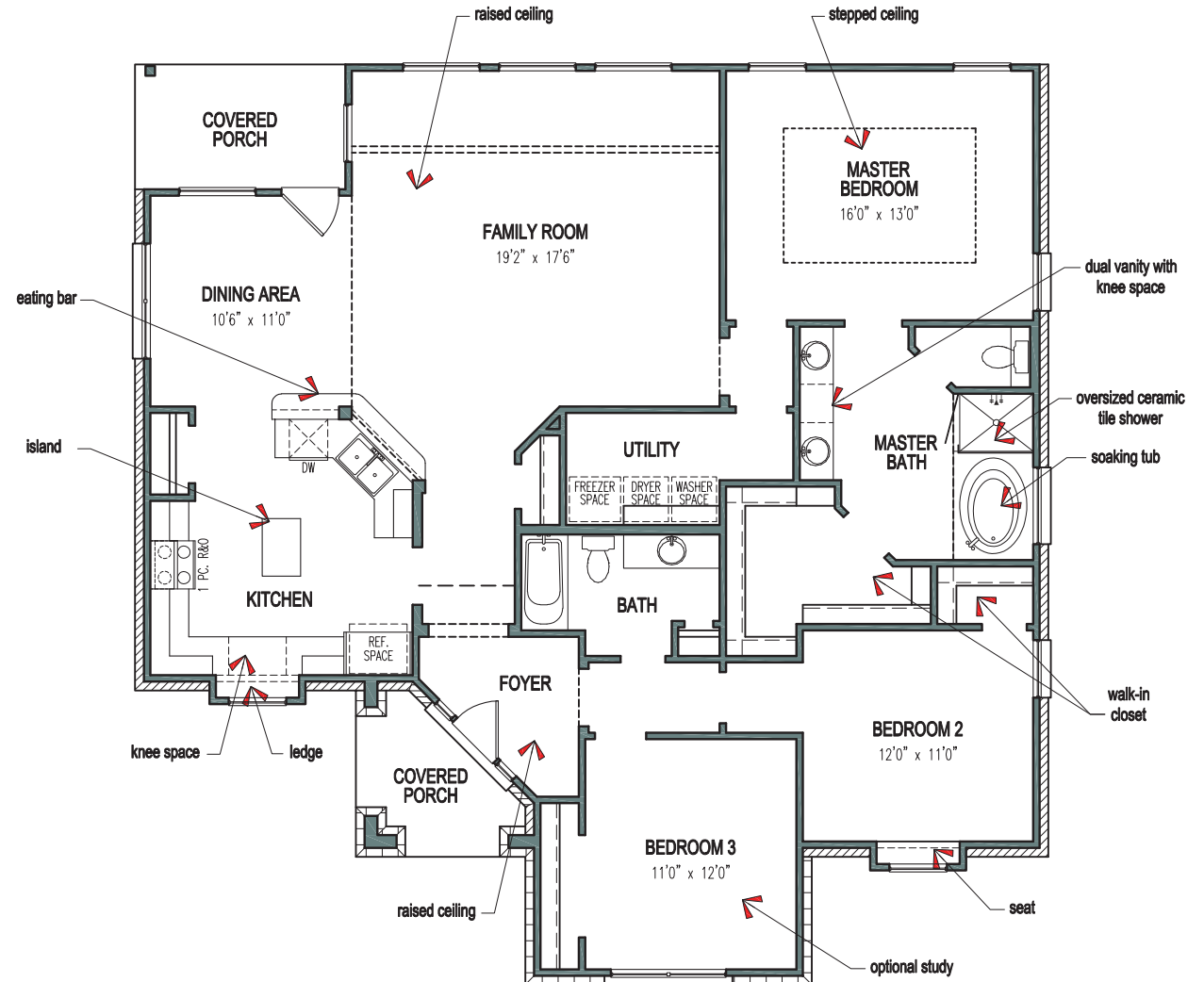

Tilson continuously improves home designs and reserves the right to modify home features and specifications without notice or obligation. Square footage is approximate and includes overall dimensions. Renderings are drawn to be substantially correct. Tilson standard features may vary by home design and/or location. Contact a Tilson Sales Associate for details.