

Breckenridge Bonus

3,943 Sq. Ft.
4 Bedrooms | 3.5 Bathrooms

TILSON
CUSTOM HOME BUILDERS



Elevation C



Elevation B

View more models and options at:

www.TilsonHomes.com

© Copyright 2019, Tilson Home Corporation

Design Centers

Angleton Boerne Bryan Georgetown Huntsville Katy
McKinney San Marcos Spring Waxahachie Weatherford

*Printed on demand and in-house to help reduce the amount of paper being used.

Breckenridge Bonus

3,943 Sq. Ft.
4 Bedrooms | 3.5 Bathrooms

TILSON
CUSTOM HOME BUILDERS

Elevation C

The Breckenridge Bonus is the perfect home for families, providing space and functionality. With 3,943 sq. ft. of living space and an attached 2 car garage, the Breckenridge Bonus has something to offer everyone. The kitchen is equipped with an oversized island with eating bar and flows into the family room with cathedral ceilings. The luxurious master suite is complete with dual walk-in closets, an oversized custom shower, and a soaking tub. The home also includes a built in desk area adjacent to the two additional bedrooms. The nearby study can easily be converted into a fourth bedroom. This home also includes a finished upstairs bonus space.

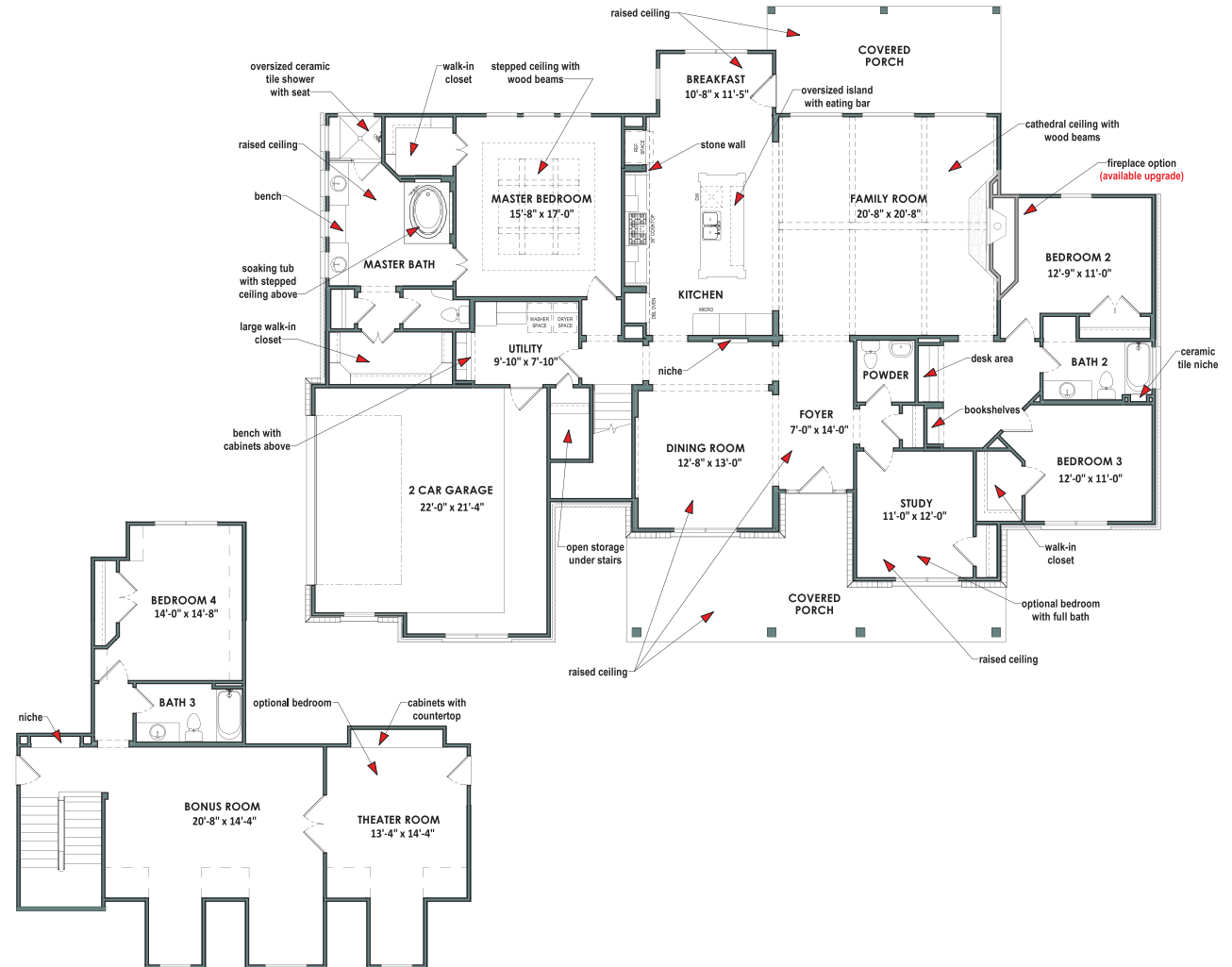

Change this plan any way you want. Move a wall, add a room - Just ask!

Tilson continuously improves home designs and reserves the right to modify home features and specifications without notice or obligation. Square footage is approximate and includes overall dimensions. Renderings are drawn to be substantially correct. Tilson standard features may vary by home design and/or location. Contact a Tilson Sales Associate for details.